

RESIDENCE ELENA

COMMUNE DE BASTIA

BATIMENT 5 - APPARTEMENT 1 - LOT 14 - TYPE 3



PLAN DE LOCALISATION



NIVEAU 00



TABLEAU DES SURFACES
LOT 14 - T3

PIECE A VIVRE	38.35m ²
CELLIER	3.53m ²
SALLE D'EAU	5.04m ²
WC	1.73m ²
DEGAGEMENT	5.05m ²
CHAMBRE 1	12.30m ²
CHAMBRE 2	12.30m ²
TOTAL	78.30m ²
TERRASSE 1	24.62m ²
TERRASSE 2	11.05m ²
PARKING COUVERT	46.81m ²
JARDIN PRIVATIF	environ 195m ²



NIVEAU 01

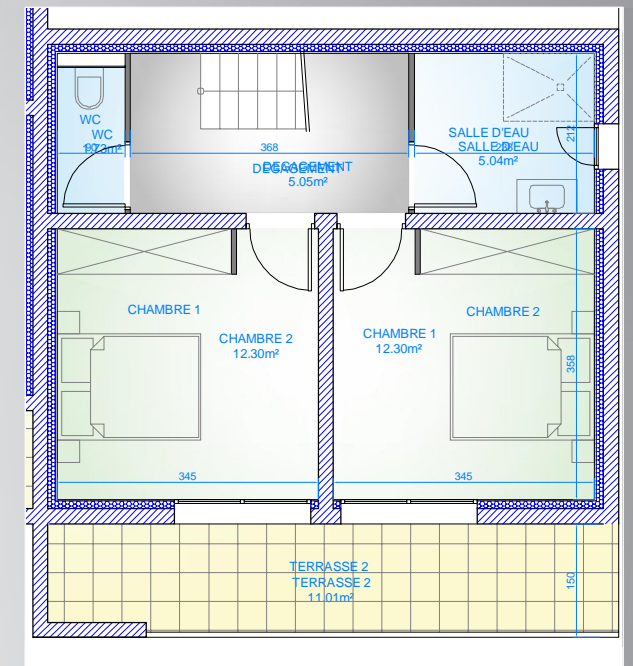
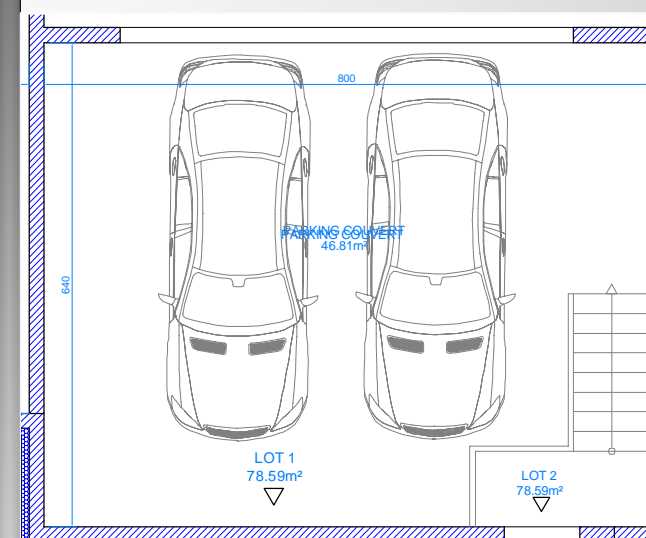
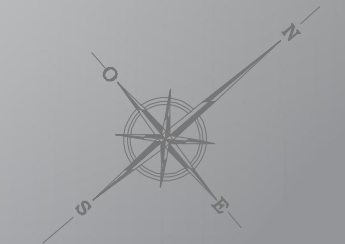
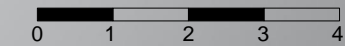